



Havering
LONDON BOROUGH

Mr Rynd Smith
Lead Member of the Examining Authority

Daniel Douglas
Team Leader Transport Planning

Place Directorate
London Borough of Havering
Havering Town Hall
Main Road
Romford
RM1 3BB

e [REDACTED]s@havering.gov.uk

text relay [REDACTED]

Date 17th November 2023

www.havering.gov.uk

London Borough of Havering (20035775) – Response to the Applicant’s D6 Submission – OTMPfC – Potential impacts of the proposed diversion routes relating to the Ockendon Road closure.

Dear Sir,

The Council has reviewed the Outline Traffic Management Plan for Construction and would wish for the Panel to take into account the potential traffic management issues arising from the proposed diversion route relating to the closure of Ockendon Road.

The key issue is the potential passing of two large HGVs given the narrowness of the roads proposed for the diversion route. Whilst it should be noted that there are no weight restrictions or lorry bans currently operating in that area, the potential constraints should be taken into account. The attached drawings illustrate these points.

We would want to secure appropriate mitigation, management and monitoring.

Yours faithfully,

Daniel Douglas

Team Leader Transport Planning

The Havering you want to be part of

The Havering you want to be part of

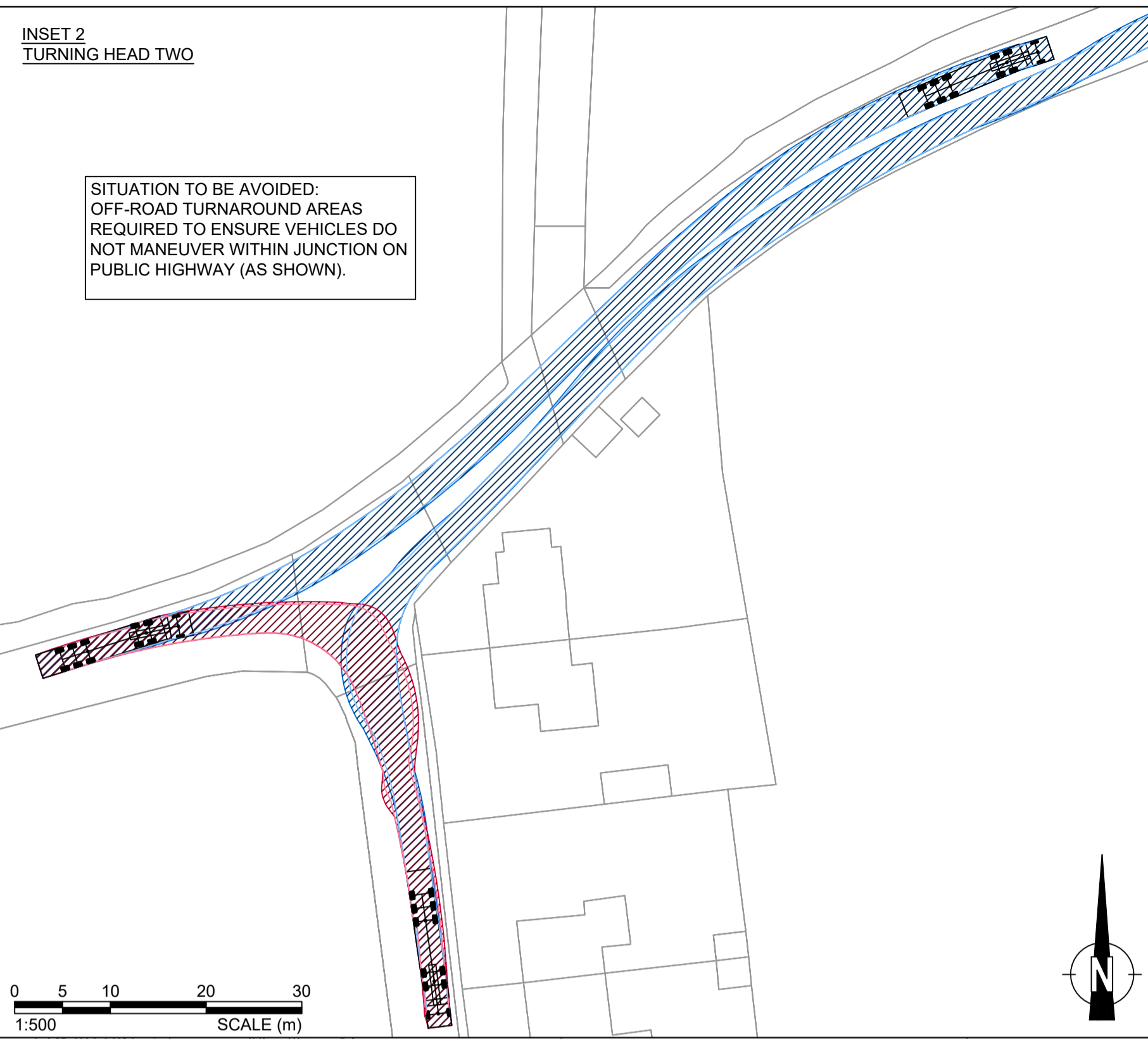
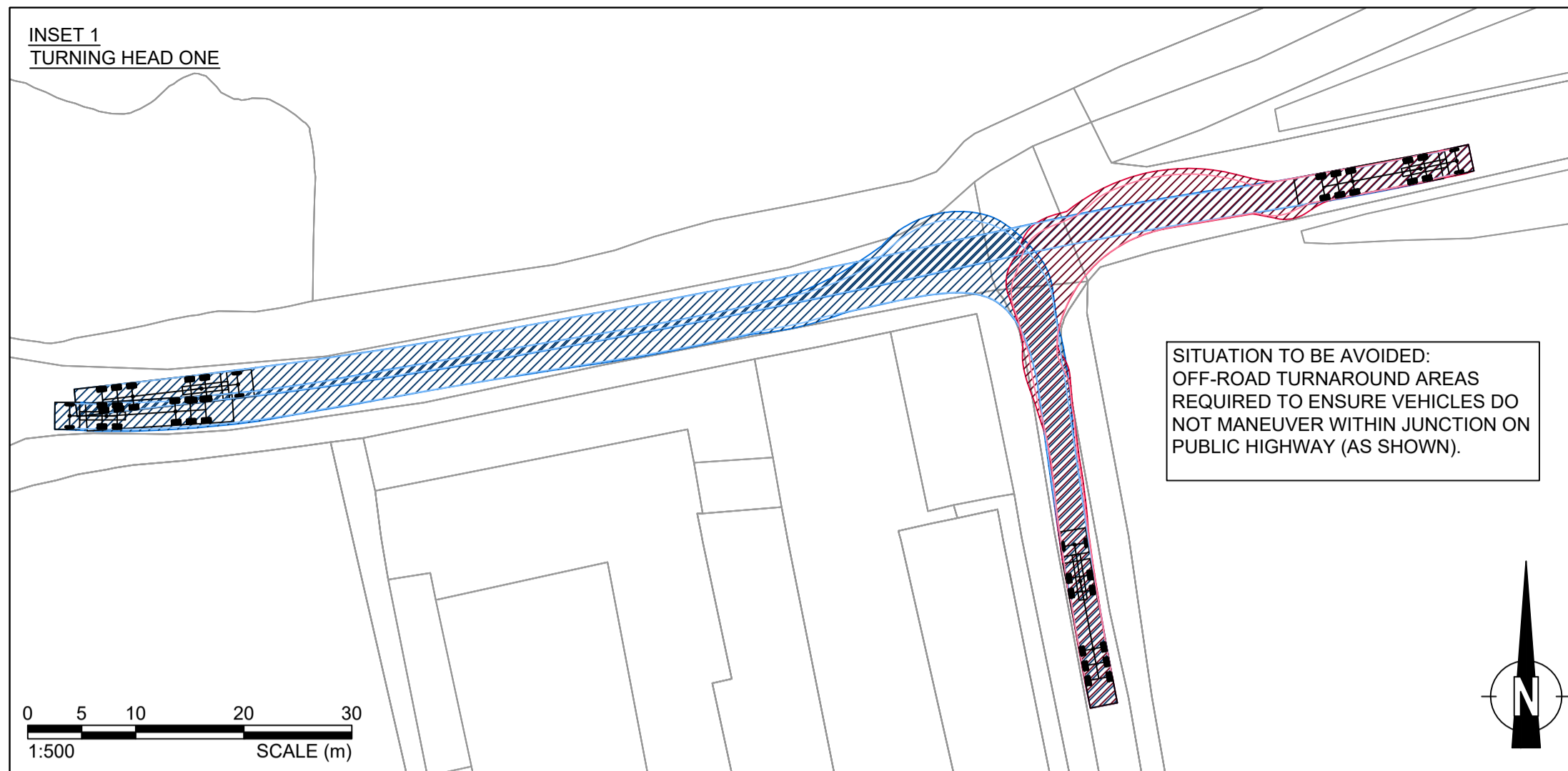

- NOTES:
- DESIGN CRITERIA IN ACCORDANCE WITH DMRB CD 109 HIGHWAY LINK DESIGN, CD 116 - GEOMETRIC DESIGN OF ROUNDABOUTS, CD 122 - GEOMETRIC DESIGN OF GRADE SEPARATED JUNCTIONS, CD 123 - GEOMETRIC DESIGN OF AT-GRADE PRIORITY & SIGNAL-CONTROLLED JUNCTIONS AND CD 127 - CROSS SECTIONS & HEADROOMS.
 - THIS DRAWING SHALL BE READ IN CONJUNCTION WITH ALL DRAWINGS WITHIN APPENDIX 0/4, THE MANUAL OF CONTRACT DOCUMENTS FOR HIGHWAY WORKS (SHW) AND THE CONTRACT SPECIFICATION.
 - HIGHWAY WORKS WHERE INDICATED BEYOND THE PROPOSED ADOPTION BOUNDARY ARE TO BE CONSTRUCTED AS PART OF THIS CONTRACT BUT TO REMAIN PRIVATE.
 - FOR APPLICABLE SECTOR SCHEMES FOR WORKMANSHIP AND MATERIALS WITH ASSOCIATED APPENDICES. REFER TO APP 1/24 QUALITY MANAGEMENT SYSTEM PART E.
 - IN ACCORDANCE WITH THE CDM REGULATIONS RESIDUAL RISKS OF SIGNIFICANCE ARE INDICATED ON THE DRAWING ONLY BY MEANS OF A HAZARD TRIANGLE WITH APPROPRIATE NOTE.
 - THE CONTRACTOR SHALL CONDUCT THE WORKS WITH DUE REGARD TO THE ECOLOGICAL AND ENVIRONMENTAL REQUIREMENTS OF THE SCHEME.
 - THE CONTRACTOR SHALL TAKE SUCH STEPS TO SAFEGUARD AGAINST CONTAMINATION OF LOCAL WATERCOURSES.
 - TEMPORARY WORKS DESIGN ASSOCIATED WITH THE CONSTRUCTION OF THE WORKS SHALL BE THE RESPONSIBILITY OF THE CONTRACTOR.

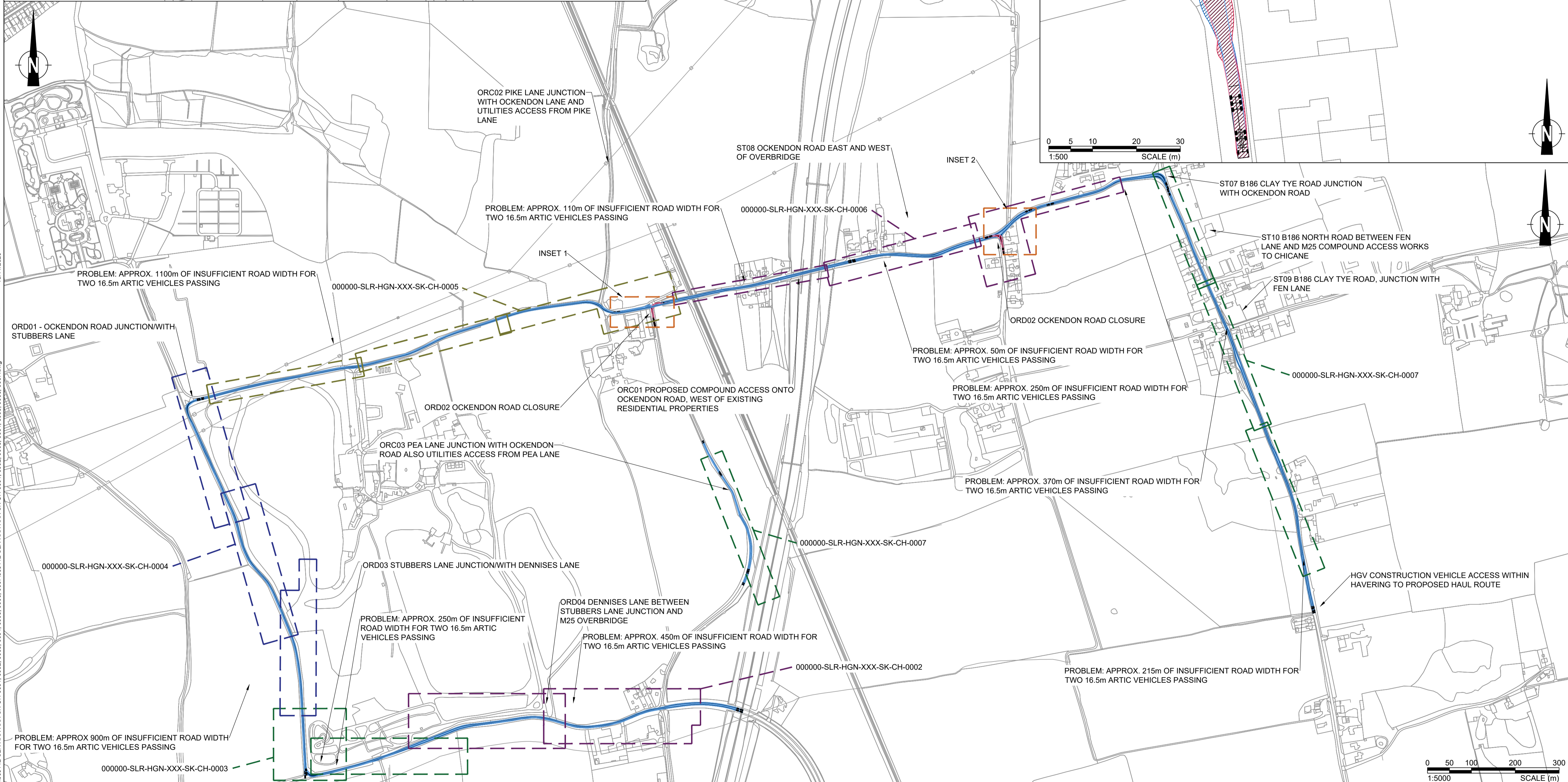

Client: LONDON BOROUGH OF HAVERING
Project: LOWER THAMES CROSSING

FOR INFORMATION				S2
Designed	Drawn	Checked	Authorised	Drawing Title
MA	MA	RT	RT	CONSTRUCTION TRAFFIC ROUTE LOCATION PLAN
Date	Date	Date	Date	
08.11.23	08.11.23	08.11.23	08.11.23	
Drawing Number	Scale	SLR Project No.		
065112-SLR-XXX-XXX-SK-CH-0001	1:5000	425.065112.00001		

Rev	Amendments	Date	By	Chk	Auth
P02	AMENDED FOLLOWING 10th NOV MEETING COMMENTS	16.11.23	JE	RT	RT
Rev	Amendments	Date	By	Chk	Auth

DRAFT VERSION ONLY

THIS DRAWING IS FOR DISCUSSION ONLY AND SHOULD BE CONSIDERED AS A DRAFT ONLY

SAFETY, HEALTH AND ENVIRONMENTAL INFORMATION

PLEASE REFER TO THE HEALTH AND SAFETY FILE FOR A FULL LIST OF THE RISKS ASSOCIATED WITH THIS WORK - THE FOLLOWING ARE THE MOST SIGNIFICANT RISKS TO BE AWARE OF:

CONSTRUCTION

- OPERATIVES TO TAKE PRECAUTIONS WHEN WORKING ADJACENT TO EXISTING WORKS WITHIN DESIGNATED METHAN GAS ZONES TO BE PROVIDED BY CONTRACTOR PRIOR TO WORKS COMMENCING
- ATTENTION TO THE EXISTENCE OF DEEPS, GULLERS AND UNDERGROUND SERVICES

ENVIRONMENT

- EXISTING WATERCOURSES IN CLOSE PROXIMITY TO WORKS, A POLLUTION PREVENTION STRATEGY AND WORKING METHOD STATEMENTS TO BE PRODUCED BY THE CONTRACTOR FOR WORKS
- CONSIDERATION GIVEN TO NOISE LEVELS GIVEN PROXIMITY TO EXISTING PROPERTIES
- CONSIDERATION GIVEN TO GROUND CONDITIONS, CONTRACTOR TO REVIEW GEOTECHNICAL REPORT PRIOR TO UNDERTAKEN EXCAVATION WORKS.

WORK CAN ONLY BE CARRIED OUT BY SUITABLY TRAINED AND BRIEFED PERSONNEL

Viewport 1

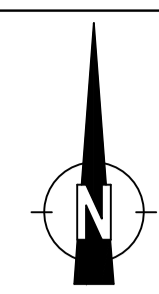
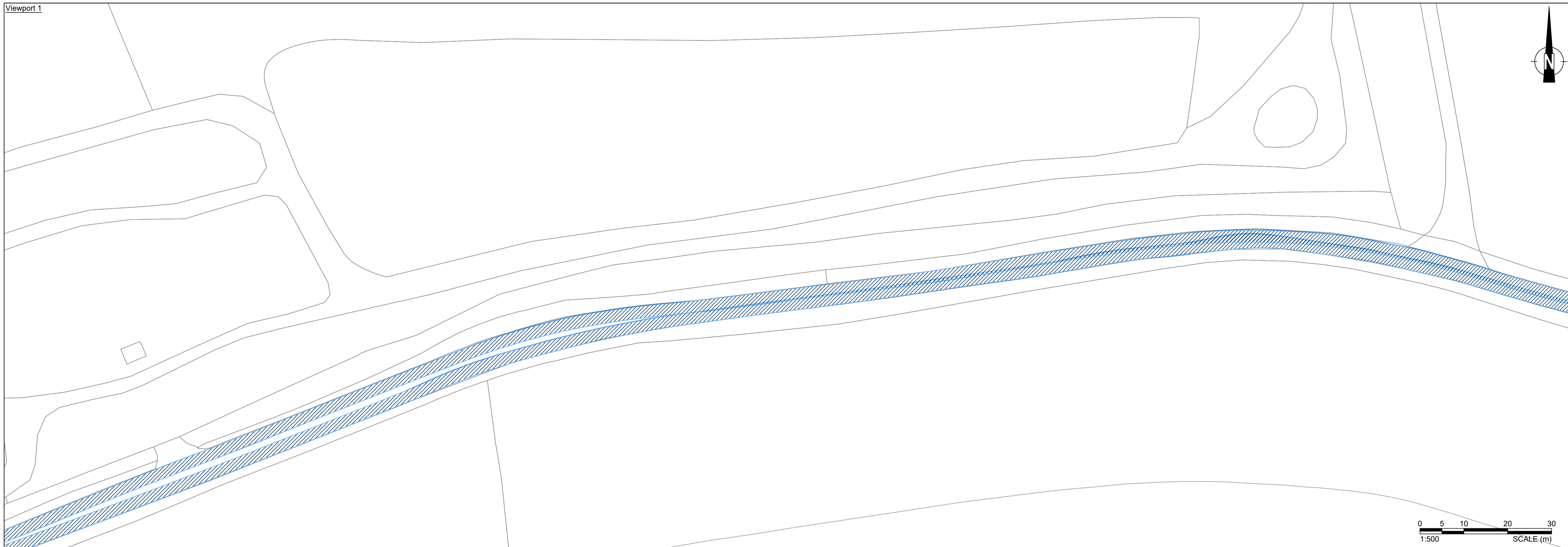

- NOTES:
- DESIGN CRITERIA IN ACCORDANCE WITH DMRB CD 109 HIGHWAY LINK DESIGN, CD 116 - GEOMETRIC DESIGN OF ROUNDABOUTS, CD 122 - GEOMETRIC DESIGN OF GRADE SEPARATED JUNCTIONS, CD 123 - GEOMETRIC DESIGN OF AT-GRADE PRIORITY & SIGNAL-CONTROLLED JUNCTIONS AND CD 127 - CROSS SECTIONS & HEADROOMS.
 - THIS DRAWING SHALL BE READ IN CONJUNCTION WITH ALL DRAWINGS WITHIN APPENDIX 0/4, THE MANUAL OF CONTRACT DOCUMENTS FOR HIGHWAY WORKS (SHW) AND THE CONTRACT SPECIFICATION.
 - HIGHWAY WORKS WHERE INDICATED BEYOND THE PROPOSED ADOPTION BOUNDARY ARE TO BE CONSTRUCTED AS PART OF THIS CONTRACT BUT TO REMAIN PRIVATE.
 - FOR APPLICABLE SECTOR SCHEMES FOR WORKMANSHIP AND MATERIALS WITH ASSOCIATED APPENDICES, REFER TO APP 1/24 QUALITY MANAGEMENT SYSTEM PART E.
 - IN ACCORDANCE WITH THE CDM REGULATIONS RESIDUAL RISKS OF SIGNIFICANCE ARE INDICATED ON THE DRAWING ONLY BY MEANS OF A HAZARD TRIANGLE WITH APPROPRIATE NOTE.
 - THE CONTRACTOR SHALL CONDUCT THE WORKS WITH DUE REGARD TO THE ECOLOGICAL AND ENVIRONMENTAL REQUIREMENTS OF THE SCHEME.
 - THE CONTRACTOR SHALL TAKE SUCH STEPS TO SAFEGUARD AGAINST CONTAMINATION OF LOCAL WATERCOURSES.
 - TEMPORARY WORKS DESIGN ASSOCIATED WITH THE CONSTRUCTION OF THE WORKS SHALL BE THE RESPONSIBILITY OF THE CONTRACTOR.



Viewport 2

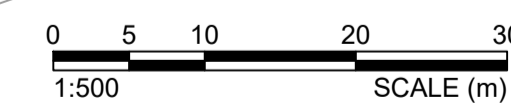
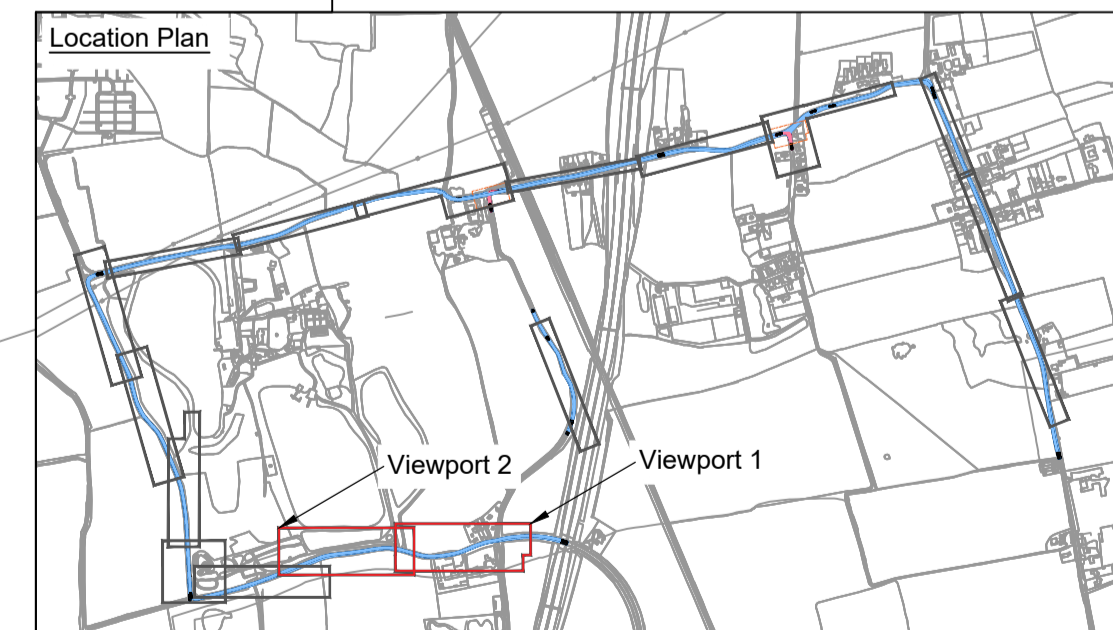
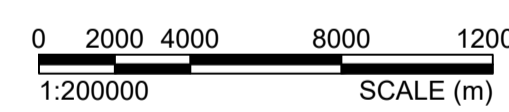

www.slrconsulting.com

Client LONDON BOROUGH OF HAVERING			
Project LOWER THAMES CROSSING			
Drawing Status & Suitability Code FOR INFORMATION		S2	
Designed JE	Drawn JE	Checked RT	Authorised RT
Date 16.11.23	Date 16.11.23	Date 16.11.23	Date 16.11.23
Drawing Number 065112-SLR-XXX-XXX-SK-CH-0002		Rev P01	Scale 1:500
SLR Project No. 425.065112.00001		@ A1	

Rev	Amendments	Date	By	Chk	Auth

Rev	Amendments	Date	By	Chk	Auth

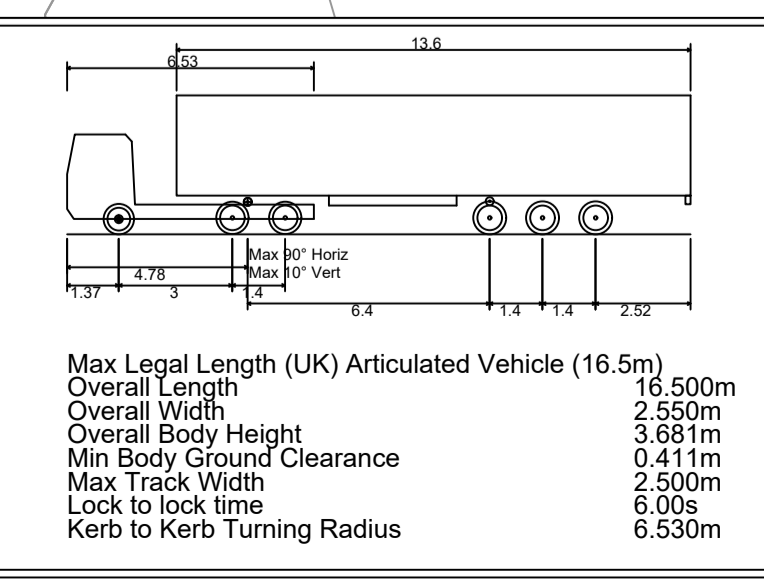

DRAFT VERSION ONLY

THIS DRAWING IS FOR DISCUSSION ONLY AND SHOULD BE CONSIDERED AS A DRAFT ONLY

Rev	Amendments	Date	By	Chk	Auth

SAFETY, HEALTH AND ENVIRONMENTAL INFORMATION

PLEASE REFER TO THE HEALTH AND SAFETY FILE FOR A FULL LIST OF THE RISKS ASSOCIATED WITH THIS WORK - THE FOLLOWING ARE THE MOST SIGNIFICANT RISKS TO BE AWARE OF:

CONSTRUCTION

- OPERATIVES TO TAKE PRECAUTIONS WHEN WORKING IN CLOSE PROXIMITY TO EXISTING WATERCOURSES AND TO BE PROVIDED WITH APPROPRIATE WORKS COMMENCING AND ENDING METHODS TO BE PROVIDED BY THE CONTRACTOR.
- ATTENTION TO THE EXISTENCE OF UNDERGROUND SERVICES AND UTILITIES.

ENVIRONMENT

- EXISTING WATERCOURSES IN CLOSE PROXIMITY TO WORKS, A POLLUTION PREVENTION STRATEGY AND WORKING METHOD STATEMENTS TO BE PRODUCED BY THE CONTRACTOR FOR APPROVAL.
- CONSIDERATION GIVEN TO NOISE LEVELS GIVEN PROXIMITY TO EXISTING PROPERTIES.
- CONSIDERATION GIVEN TO GROUND CONDITIONS, CONTRACTOR TO REVIEW GEOTECHNICAL REPORT PRIOR TO UNDERTAKEN EXCAVATION WORKS.

WORK CAN ONLY BE CARRIED OUT BY SUITABLY TRAINED AND BRIEFED PERSONNEL

Viewport 1

Viewport 2

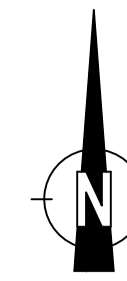

- NOTES:
- DESIGN CRITERIA IN ACCORDANCE WITH DMRB CD 109 HIGHWAY LINK DESIGN, CD 116 - GEOMETRIC DESIGN OF ROUNDABOUTS, CD 122 - GEOMETRIC DESIGN OF GRADE SEPARATED JUNCTIONS, CD 123 - GEOMETRIC DESIGN OF AT-GRADE PRIORITY & SIGNAL-CONTROLLED JUNCTIONS AND CD 127 - CROSS SECTIONS & HEADROOMS.
 - THIS DRAWING SHALL BE READ IN CONJUNCTION WITH ALL DRAWINGS WITHIN APPENDIX 0/4, THE MANUAL OF CONTRACT DOCUMENTS FOR HIGHWAY WORKS (SHW) AND THE CONTRACT SPECIFICATION.
 - HIGHWAY WORKS WHERE INDICATED BEYOND THE PROPOSED ADOPTION BOUNDARY ARE TO BE CONSTRUCTED AS PART OF THIS CONTRACT BUT TO REMAIN PRIVATE.
 - FOR APPLICABLE SECTOR SCHEMES FOR WORKMANSHIP AND MATERIALS WITH ASSOCIATED APPENDICES, REFER TO APP 1/24 QUALITY MANAGEMENT SYSTEM PART E.
 - IN ACCORDANCE WITH THE CDM REGULATIONS RESIDUAL RISKS OF SIGNIFICANCE ARE INDICATED ON THE DRAWING ONLY BY MEANS OF A HAZARD TRIANGLE WITH APPROPRIATE NOTE.
 - THE CONTRACTOR SHALL CONDUCT THE WORKS WITH DUE REGARD TO THE ECOLOGICAL AND ENVIRONMENTAL REQUIREMENTS OF THE SCHEME.
 - THE CONTRACTOR SHALL TAKE SUCH STEPS TO SAFEGUARD AGAINST CONTAMINATION OF LOCAL WATERCOURSES.
 - TEMPORARY WORKS DESIGN ASSOCIATED WITH THE CONSTRUCTION OF THE WORKS SHALL BE THE RESPONSIBILITY OF THE CONTRACTOR.

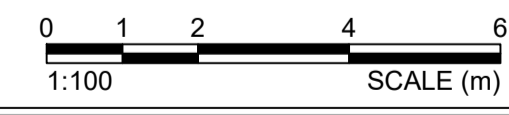
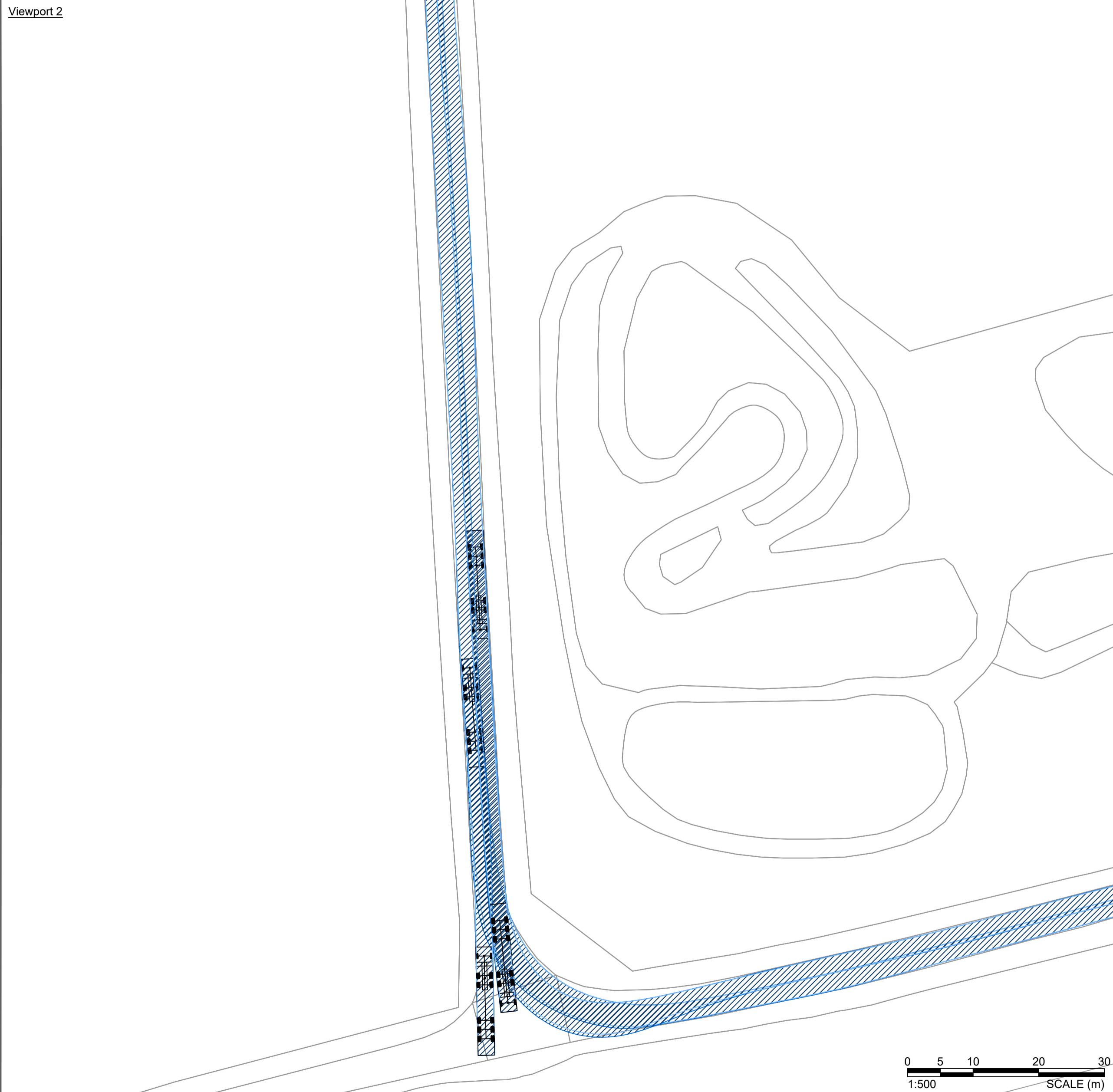
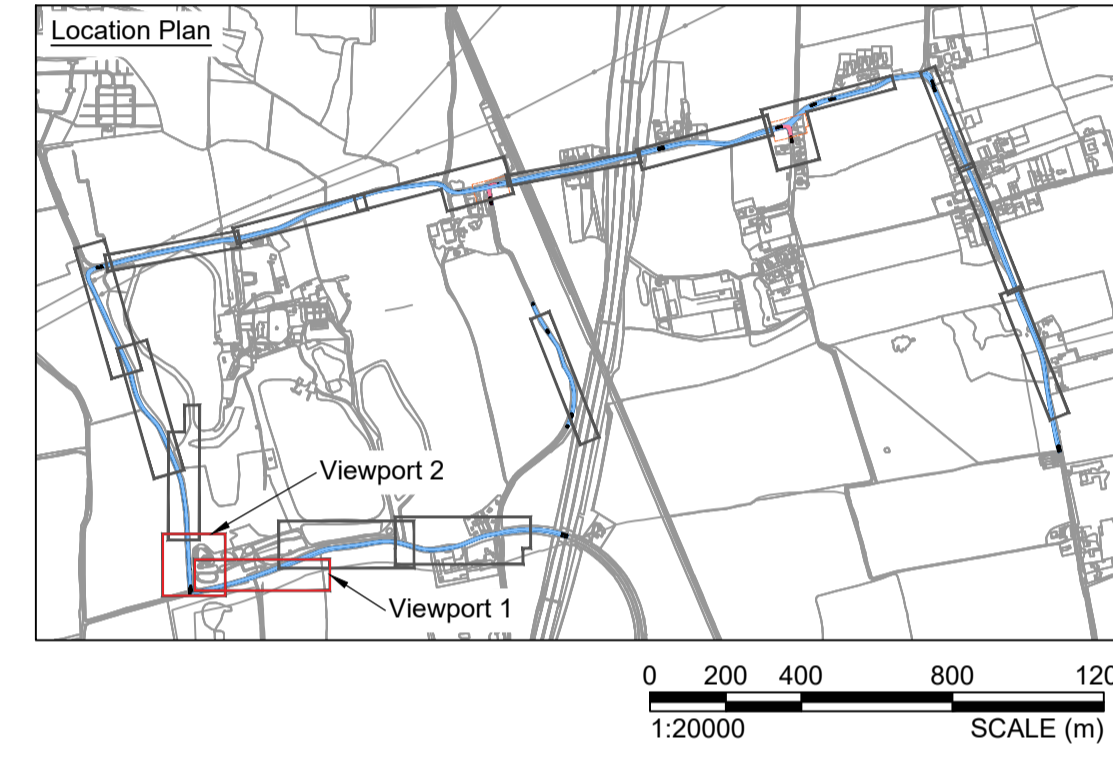

www.slrconsulting.com

FOR INFORMATION S2

Designed	Drawn	Checked	Authorised
JE	JE	RT	RT
Date	Date	Date	Date
16.11.23	16.11.23	16.11.23	16.11.23

Drawing Number: 065112-SLR-XXX-XXX-SK-CH-0003

Rev: P01

Client: LONDON BOROUGH OF HAVERING

Project: LOWER THAMES CROSSING

Drawing Title: CONSTRUCTION TRAFFIC ROUTE SHEET 2 OF 6

Scale: 1:500

SLR Project No: @ A1 425.065112.00001

Rev	Amendments	Date	By	Chk	Auth

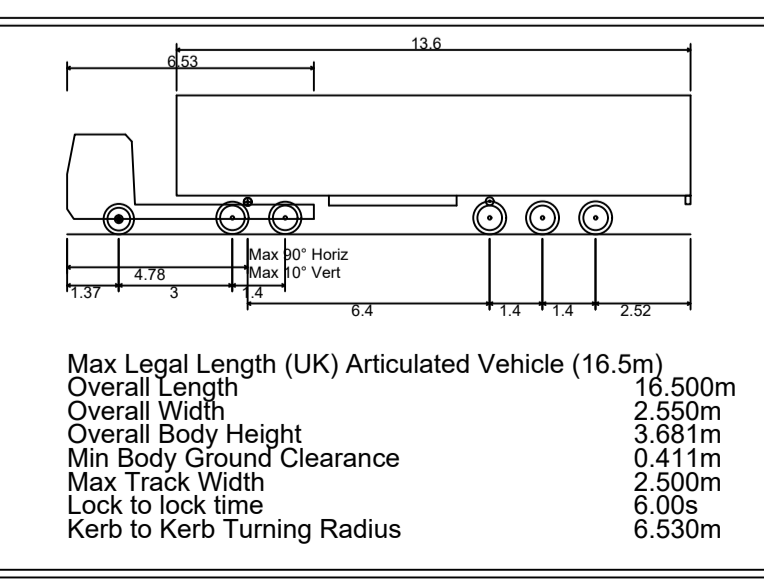

DRAFT VERSION ONLY

THIS DRAWING IS FOR DISCUSSION ONLY AND SHOULD BE CONSIDERED AS A DRAFT ONLY

SAFETY, HEALTH AND ENVIRONMENTAL INFORMATION

PLEASE REFER TO THE HEALTH AND SAFETY FILE FOR A FULL LIST OF THE RISKS ASSOCIATED WITH THIS WORK - THE FOLLOWING ARE THE MOST SIGNIFICANT RISKS TO BE AWARE OF:

CONSTRUCTION

- OPERATIVES TO TAKE PRECAUTIONS WHEN WORKING IN CLOSE PROXIMITY TO EXISTING PROPERTIES WITHIN DESIGNATED METHUEN TO BE PROVIDED BY CONTRACTOR PRIOR TO WORKS COMMENCING
- ATTENTION TO THE EXISTENCE OF SERVICES UNDERGROUND AND OVERHEAD LINES

ENVIRONMENT

- EXISTING WATERCOURSES IN CLOSE PROXIMITY TO WORKS, A POLLUTION PREVENTION STRATEGY AND WORKING METHOD STATEMENTS TO BE PRODUCED BY THE CONTRACTOR FOR ALL WORKS
- CONSIDERATION GIVEN TO NOISE LEVELS GIVEN PROXIMITY TO EXISTING PROPERTIES
- CONSIDERATION GIVEN TO GROUND CONDITIONS, CONTRACTOR TO REVIEW GEOTECHNICAL REPORT PRIOR TO UNDERTAKEN EXCAVATION WORKS

WORK CAN ONLY BE CARRIED OUT BY SUITABLY TRAINED AND BRIEFED PERSONNEL



- NOTES:
- DESIGN CRITERIA IN ACCORDANCE WITH DMRB CD 109 HIGHWAY LINK DESIGN, CD 116 - GEOMETRIC DESIGN OF ROUNDABOUTS, CD 122 - GEOMETRIC DESIGN OF GRADE SEPARATED JUNCTIONS, CD 123 - GEOMETRIC DESIGN OF AT-GRADE PRIORITY & SIGNAL-CONTROLLED JUNCTIONS AND CD 127 - CROSS SECTIONS & HEADROOMS.
 - THIS DRAWING SHALL BE READ IN CONJUNCTION WITH ALL DRAWINGS WITHIN APPENDIX 0/4, THE MANUAL OF CONTRACT DOCUMENTS FOR HIGHWAY WORKS (SHW) AND THE CONTRACT SPECIFICATION.
 - HIGHWAY WORKS WHERE INDICATED BEYOND THE PROPOSED ADOPTION BOUNDARY ARE TO BE CONSTRUCTED AS PART OF THIS CONTRACT BUT TO REMAIN PRIVATE.
 - FOR APPLICABLE SECTOR SCHEMES FOR WORKMANSHIP AND MATERIALS WITH ASSOCIATED APPENDICES, REFER TO APP 1/24 QUALITY MANAGEMENT SYSTEM PART E.
 - IN ACCORDANCE WITH THE CDM REGULATIONS RESIDUAL RISKS OF SIGNIFICANCE ARE INDICATED ON THE DRAWING ONLY BY MEANS OF A HAZARD TRIANGLE WITH APPROPRIATE NOTE.
 - THE CONTRACTOR SHALL CONDUCT THE WORKS WITH DUE REGARD TO THE ECOLOGICAL AND ENVIRONMENTAL REQUIREMENTS OF THE SCHEME.
 - THE CONTRACTOR SHALL TAKE SUCH STEPS TO SAFEGUARD AGAINST CONTAMINATION OF LOCAL WATERCOURSES.
 - TEMPORARY WORKS DESIGN ASSOCIATED WITH THE CONSTRUCTION OF THE WORKS SHALL BE THE RESPONSIBILITY OF THE CONTRACTOR.

C:\Users\lucy.levington\Desktop\Lower Thames Crossing\25_P65124_00001\Output\065112-SLR-XXX-XXX-SK-CH-0001_0002_0003_0004_0005_0006_0007.dwg 16/11/2023

www.slrconsulting.com

FOR INFORMATION			
Designed	Drawn	Checked	Authorised
JE	JE	RT	RT
Date	Date	Date	Date
16.11.23	16.11.23	16.11.23	16.11.23
Drawing Number			Rev
065112-SLR-XXX-XXX-SK-CH-0004			P01

Client
LONDON BOROUGH OF HAVERING

Project
LOWER THAMES CROSSING

Drawing Title
CONSTRUCTION TRAFFIC ROUTE
SHEET 3 OF 6

Scale
1:500

SLR Project No.
425.065112.00001

Rev	Amendments	Date	By	Chk	Auth

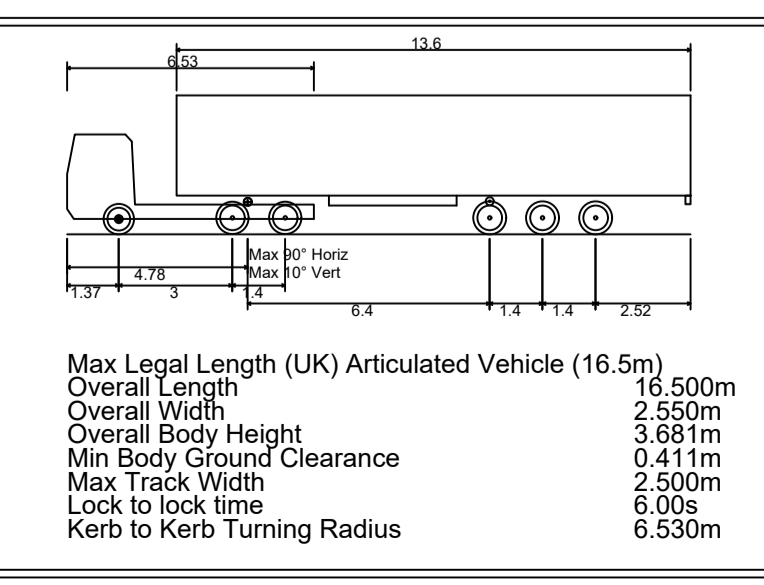

DRAFT VERSION ONLY

THIS DRAWING IS FOR DISCUSSION ONLY AND SHOULD BE CONSIDERED AS A DRAFT ONLY

Rev	Amendments	Date	By	Chk	Auth

SAFETY, HEALTH AND ENVIRONMENTAL INFORMATION

PLEASE REFER TO THE HEALTH AND SAFETY FILE FOR A FULL LIST OF THE RISKS ASSOCIATED WITH THIS WORK - THE FOLLOWING ARE THE MOST SIGNIFICANT RISKS TO BE AWARE OF.

CONSTRUCTION

- OPERATIVES TO TAKE PRECAUTIONS WHEN WORKING IN CLOSE PROXIMITY TO EXISTING WATERCOURSES. POLLUTION PREVENTION STATEMENTS TO BE PRODUCED BY THE CONTRACTOR PRIOR TO WORKS COMMENCING.
- ATTENTION TO THE EXISTENCE OF UNDEVELOPED UNDERGROUND AND OVERHEAD UTILITIES.

ENVIRONMENT

- EXISTING WATERCOURSES IN CLOSE PROXIMITY TO WORKS. A POLLUTION PREVENTION STATEMENT AND WORKING METHOD STATEMENTS TO BE PRODUCED BY THE CONTRACTOR FOR ALL WORKS.
- CONSIDERATION GIVEN TO NOISE LEVELS GIVEN PROXIMITY TO EXISTING PROPERTIES.
- CONSIDERATION GIVEN TO GROUND CONDITIONS. CONTRACTOR TO REVIEW GEOTECHNICAL REPORT PRIOR TO UNDERTAKEN EXCAVATION WORKS.

WORK CAN ONLY BE CARRIED OUT BY SUITABLY TRAINED AND BRIEFED PERSONNEL.



Viewport 1

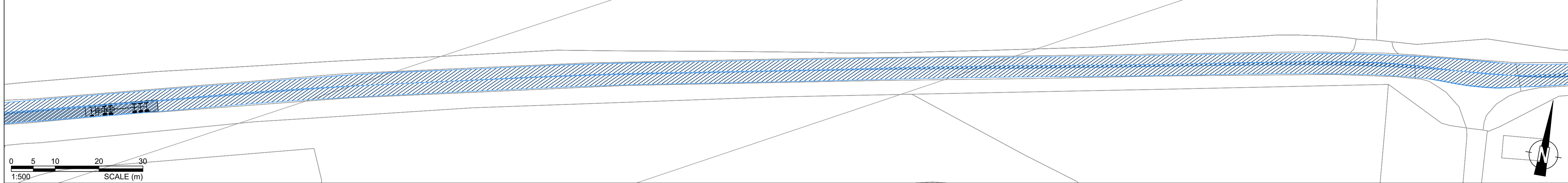

Viewport 2

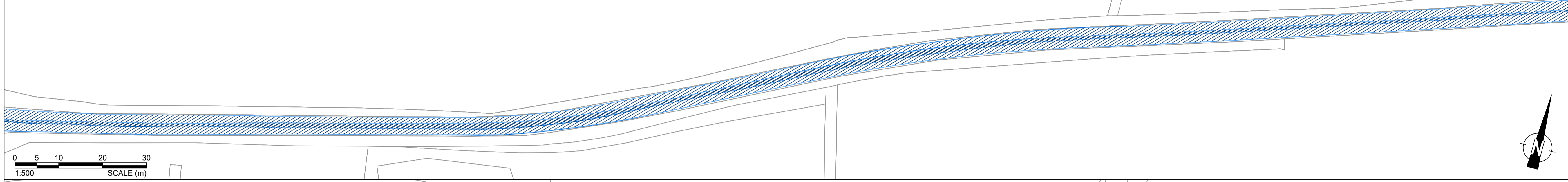

Viewport 3

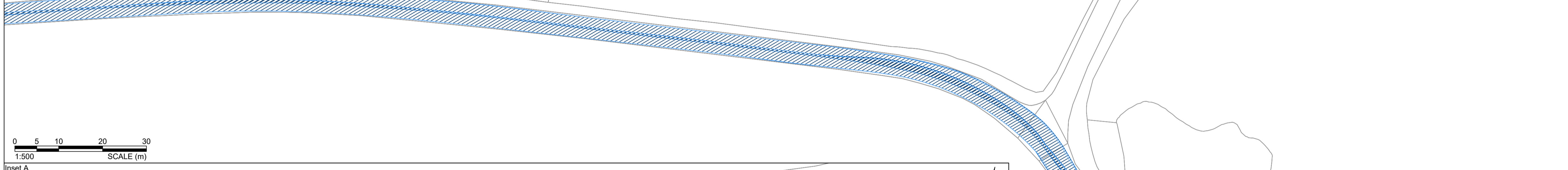

Inset A

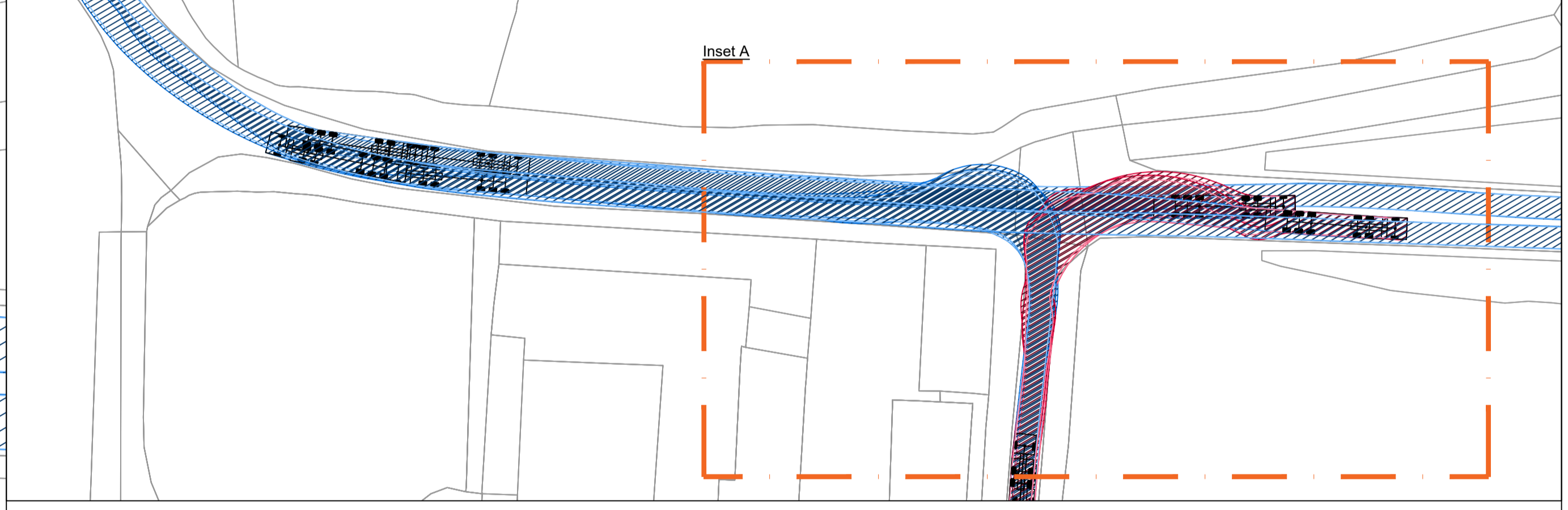
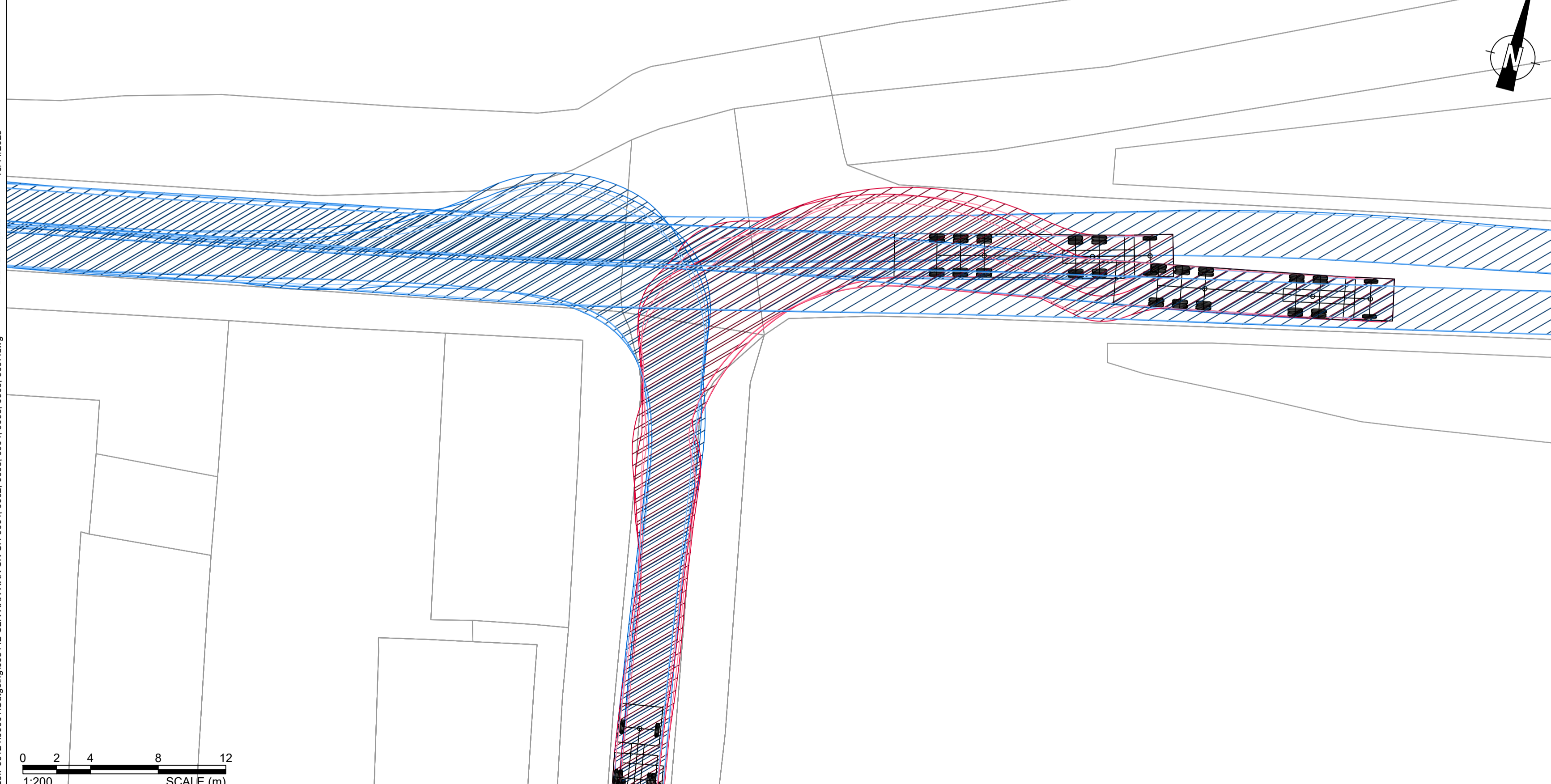

- NOTES:
- DESIGN CRITERIA IN ACCORDANCE WITH DMRB CD 109 HIGHWAY LINK DESIGN, CD 116 - GEOMETRIC DESIGN OF ROUNDABOUTS, CD 122 - GEOMETRIC DESIGN OF GRADE SEPARATED JUNCTIONS, CD 123 - GEOMETRIC DESIGN OF AT-GRADE PRIORITY & SIGNAL-CONTROLLED JUNCTIONS AND CD 127 - CROSS SECTIONS & HEADROOMS.
 - THIS DRAWING SHALL BE READ IN CONJUNCTION WITH ALL DRAWINGS WITHIN APPENDIX 0/4, THE MANUAL OF CONTRACT DOCUMENTS FOR HIGHWAY WORKS (SHW) AND THE CONTRACT SPECIFICATION.
 - HIGHWAY WORKS WHERE INDICATED BEYOND THE PROPOSED ADOPTION BOUNDARY ARE TO BE CONSTRUCTED AS PART OF THIS CONTRACT BUT TO REMAIN PRIVATE.
 - FOR APPLICABLE SECTOR SCHEMES FOR WORKMANSHIP AND MATERIALS WITH ASSOCIATED APPENDICES, REFER TO APP 1/24 QUALITY MANAGEMENT SYSTEM PART E.
 - IN ACCORDANCE WITH THE CDM REGULATIONS RESIDUAL RISKS OF SIGNIFICANCE ARE INDICATED ON THE DRAWING ONLY BY MEANS OF A HAZARD TRIANGLE WITH APPROPRIATE NOTE.
 - THE CONTRACTOR SHALL CONDUCT THE WORKS WITH DUE REGARD TO THE ECOLOGICAL AND ENVIRONMENTAL REQUIREMENTS OF THE SCHEME.
 - THE CONTRACTOR SHALL TAKE SUCH STEPS TO SAFEGUARD AGAINST CONTAMINATION OF LOCAL WATERCOURSES.
 - TEMPORARY WORKS DESIGN ASSOCIATED WITH THE CONSTRUCTION OF THE WORKS SHALL BE THE RESPONSIBILITY OF THE CONTRACTOR.

www.slrconsulting.com

FOR INFORMATION			
Designed	Drawn	Checked	Authorised
JE	JE	RT	RT
Date	Date	Date	Date
16.11.23	16.11.23	16.11.23	16.11.23
Drawing Number		Rev	Scale
065112-SLR-XXX-XXX-SK-CH-0005		P01	1:500

Client
LONDON BOROUGH OF HAVERING

Project
LOWER THAMES CROSSING

Drawing Title
CONSTRUCTION TRAFFIC ROUTE
SHEET 4 OF 6

Rev	Amendments	Date	By	Chk	Auth

Rev	Amendments	Date	By	Chk	Auth

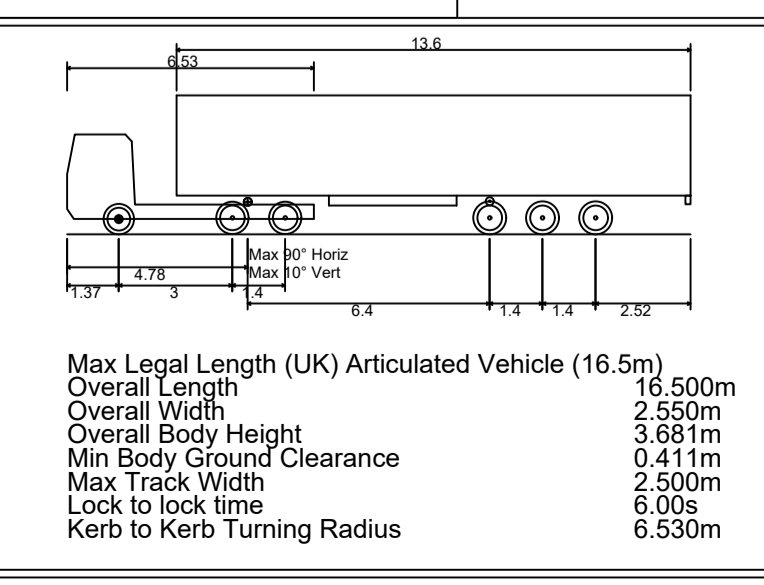

DRAFT VERSION ONLY

THIS DRAWING IS FOR DISCUSSION ONLY AND SHOULD BE CONSIDERED AS A DRAFT ONLY

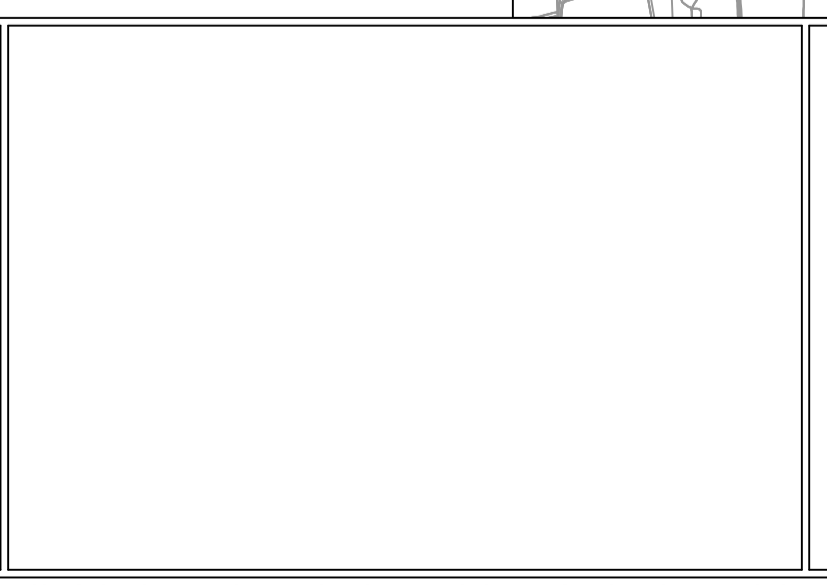

SAFETY, HEALTH AND ENVIRONMENTAL INFORMATION

PLEASE REFER TO THE HEALTH AND SAFETY FILE FOR A FULL LIST OF THE RISKS ASSOCIATED WITH THIS WORK - THE FOLLOWING ARE THE MOST SIGNIFICANT RISKS TO BE AWARE OF:

CONSTRUCTION

- OPERATIVES TO TAKE PRECAUTIONS WHEN WORKING IN CLOSE PROXIMITY TO WORKS. A POLLUTION PREVENTION STRATEGY AND WORKING METHOD STATEMENTS TO BE PRODUCED BY THE CONTRACTOR PRIOR TO WORKS COMMENCING.
- ATTENTION TO BE GIVEN TO THE EXISTENCE OF SERVICES (UNDERGROUND AND OVERHEAD LINES).

ENVIRONMENT

- EXISTING WATERCOURSES IN CLOSE PROXIMITY TO WORKS. A POLLUTION PREVENTION STRATEGY AND WORKING METHOD STATEMENTS TO BE PRODUCED BY THE CONTRACTOR PRIOR TO WORKS COMMENCING.
- CONSIDERATION TO BE GIVEN TO NOISE LEVELS GIVEN PROXIMITY TO EXISTING PROPERTIES.
- CONSIDERATION TO BE GIVEN TO GROUND CONDITIONS. CONTRACTOR TO REVIEW GEOTECHNICAL REPORT PRIOR TO UNDERTAKEN EXCAVATION WORKS.

WORK CAN ONLY BE CARRIED OUT BY SUITABLY TRAINED AND BRIEFED PERSONNEL

- NOTES:
- DESIGN CRITERIA IN ACCORDANCE WITH DMRB CD 109 HIGHWAY LINK DESIGN, CD 116 - GEOMETRIC DESIGN OF ROUNDABOUTS, CD 122 - GEOMETRIC DESIGN OF GRADE SEPARATED JUNCTIONS, CD 123 - GEOMETRIC DESIGN OF AT-GRADE PRIORITY & SIGNAL-CONTROLLED JUNCTIONS AND CD 127 - CROSS SECTIONS & HEADROOMS.
 - THIS DRAWING SHALL BE READ IN CONJUNCTION WITH ALL DRAWINGS WITHIN APPENDIX 0/4, THE MANUAL OF CONTRACT DOCUMENTS FOR HIGHWAY WORKS (SHW) AND THE CONTRACT SPECIFICATION.
 - HIGHWAY WORKS WHERE INDICATED BEYOND THE PROPOSED ADOPTION BOUNDARY ARE TO BE CONSTRUCTED AS PART OF THIS CONTRACT BUT TO REMAIN PRIVATE.
 - FOR APPLICABLE SECTOR SCHEMES FOR WORKMANSHIP AND MATERIALS WITH ASSOCIATED APPENDICES, REFER TO APP 1/24 QUALITY MANAGEMENT SYSTEM PART E.
 - IN ACCORDANCE WITH THE CDM REGULATIONS RESIDUAL RISKS OF SIGNIFICANCE ARE INDICATED ON THE DRAWING ONLY BY MEANS OF A HAZARD TRIANGLE WITH APPROPRIATE NOTE.
 - THE CONTRACTOR SHALL CONDUCT THE WORKS WITH DUE REGARD TO THE ECOLOGICAL AND ENVIRONMENTAL REQUIREMENTS OF THE SCHEME.
 - THE CONTRACTOR SHALL TAKE SUCH STEPS TO SAFEGUARD AGAINST CONTAMINATION OF LOCAL WATERCOURSES.
 - TEMPORARY WORKS DESIGN ASSOCIATED WITH THE CONSTRUCTION OF THE WORKS SHALL BE THE RESPONSIBILITY OF THE CONTRACTOR.

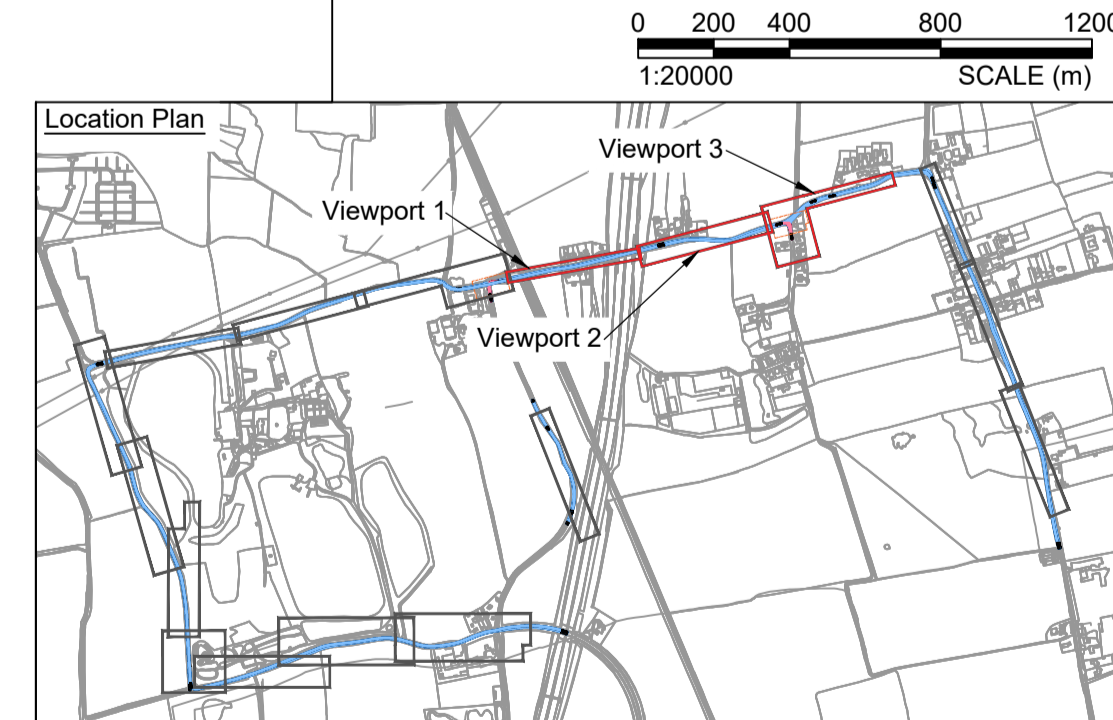
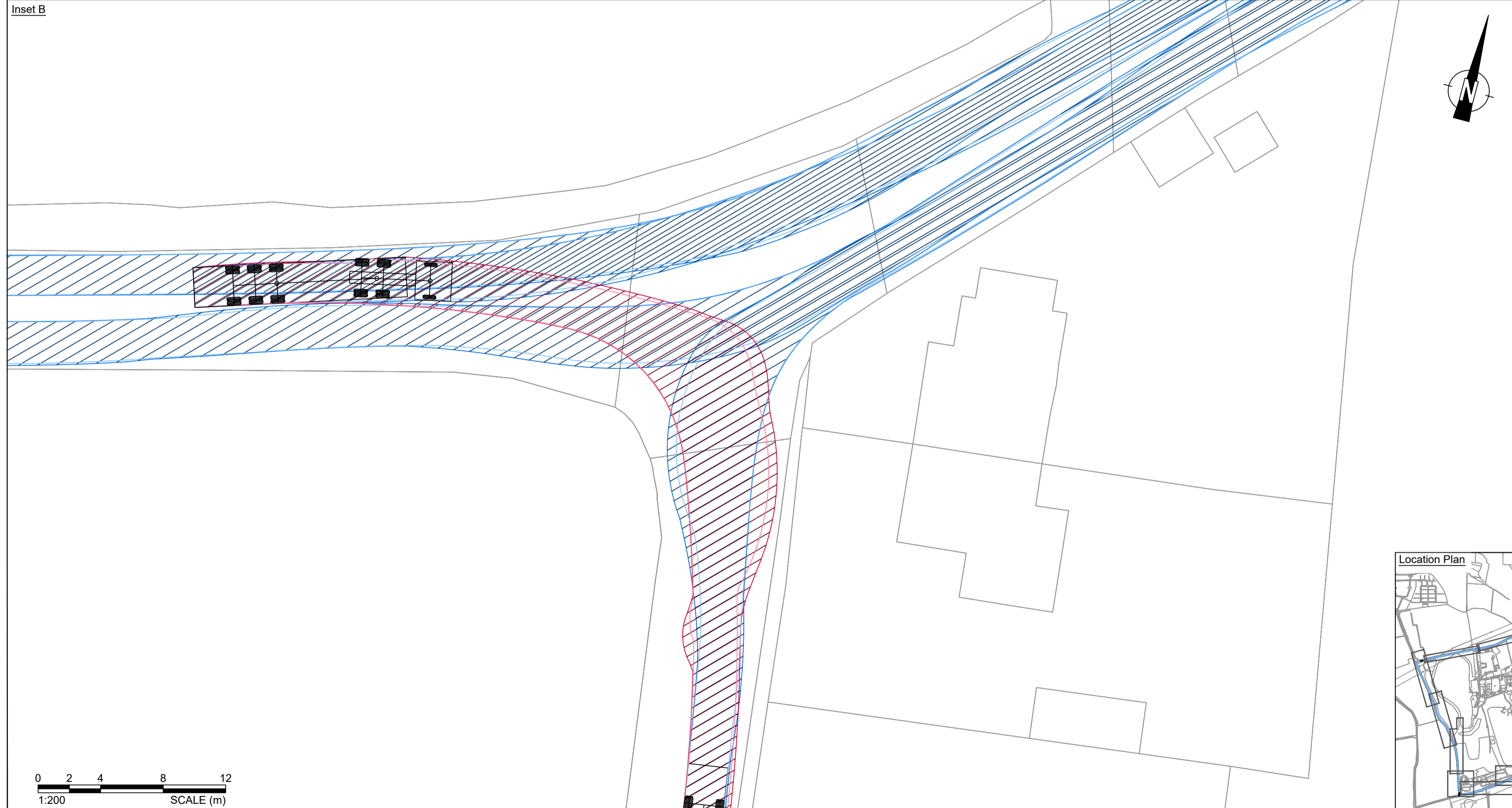
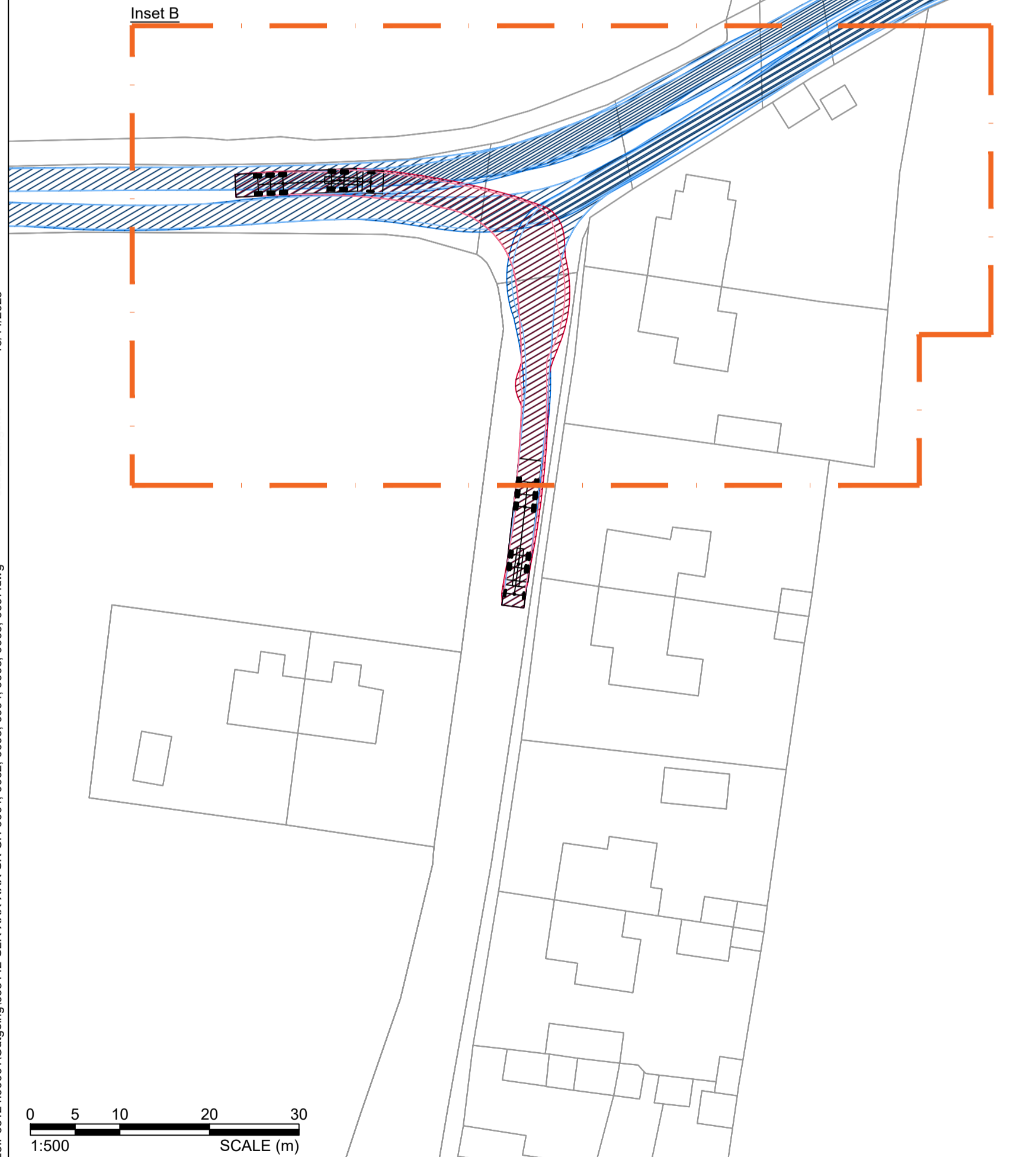
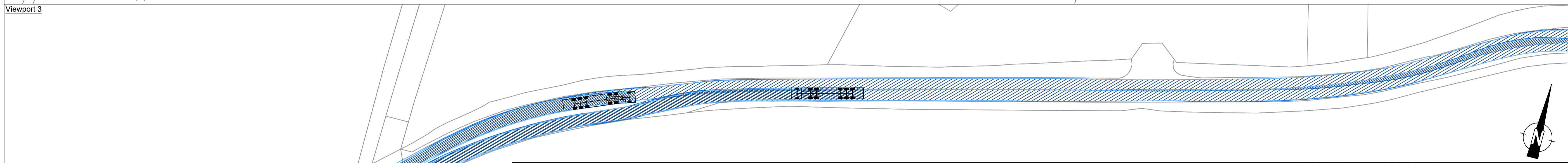
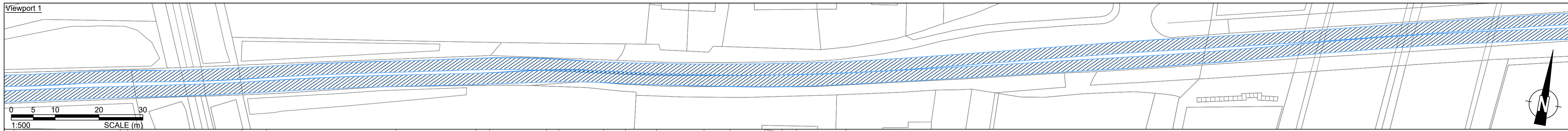

SLR
www.slrconsulting.com

FOR INFORMATION S2

Designed	Drawn	Checked	Authorised
JE	JE	RT	RT
Date	Date	Date	Date
16.11.23	16.11.23	16.11.23	16.11.23

Drawing Number: **065112-SLR-XXX-XXX-SK-CH-0006**

Client: LONDON BOROUGH OF HAVERING

Project: LOWER THAMES CROSSING

Drawing Title: CONSTRUCTION TRAFFIC ROUTE SHEET 5 OF 6

Scale: 1:500

Rev: P01

SLR Project No: 425.065112.00001

Rev	Amendments	Date	By	Chk	Auth

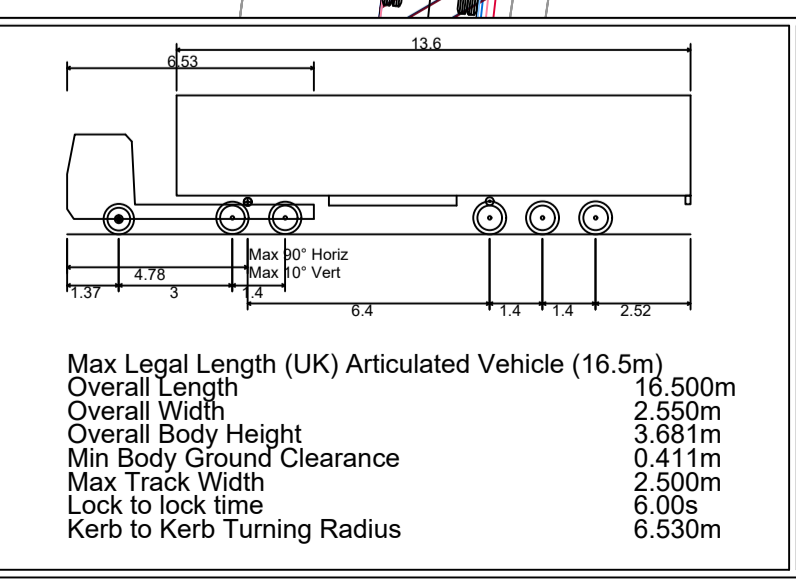

DRAFT VERSION ONLY

THIS DRAWING IS FOR DISCUSSION ONLY AND SHOULD BE CONSIDERED AS A DRAFT ONLY

Rev	Amendments	Date	By	Chk	Auth

SAFETY, HEALTH AND ENVIRONMENTAL INFORMATION

PLEASE REFER TO THE HEALTH AND SAFETY FILE FOR A FULL LIST OF THE RISKS ASSOCIATED WITH THIS WORK - THE FOLLOWING ARE THE MOST SIGNIFICANT RISKS TO BE AWARE OF:

CONSTRUCTION

- OPERATIVES TO TAKE PRECAUTIONS WHEN WORKING ADJACENT TO OR WITHIN DESIGNATED METHAN GAS ZONES TO BE PROVIDED BY THE CONTRACTOR PRIOR TO WORKS COMMENCING.
- ATTENTION TO THE EXISTENCE OF UNDETECTED UNDERGROUND SERVICES.

ENVIRONMENT

- EXISTING WATERCOURSES CLOSE PROXIMITY TO WORKS, A POLLUTION PREVENTION STRATEGY AND WORKING METHOD STATEMENTS TO BE PRODUCED BY THE CONTRACTOR FOR ALL WORKS.
- CONSIDERATION GIVEN TO NOISE LEVELS GIVEN PROXIMITY TO EXISTING PROPERTIES.
- CONSIDERATION GIVEN TO GROUND CONDITIONS, CONTRACTOR TO REVIEW GEOTECHNICAL REPORT PRIOR TO UNDERTAKEN EXCAVATION WORKS.

WORK CAN ONLY BE CARRIED OUT BY SUITABLY TRAINED AND BRIEFED PERSONNEL



- NOTES:
- DESIGN CRITERIA IN ACCORDANCE WITH DMRB CD 109 HIGHWAY LINK DESIGN, CD 116 - GEOMETRIC DESIGN OF ROUNDABOUTS, CD 122 - GEOMETRIC DESIGN OF GRADE SEPARATED JUNCTIONS, CD 123 - GEOMETRIC DESIGN OF AT-GRADE PRIORITY & SIGNAL-CONTROLLED JUNCTIONS AND CD 127 - CROSS SECTIONS & HEADROOMS.
 - THIS DRAWING SHALL BE READ IN CONJUNCTION WITH ALL DRAWINGS WITHIN APPENDIX 0/4, THE MANUAL OF CONTRACT DOCUMENTS FOR HIGHWAY WORKS (SHW) AND THE CONTRACT SPECIFICATION.
 - HIGHWAY WORKS WHERE INDICATED BEYOND THE PROPOSED ADOPTION BOUNDARY ARE TO BE CONSTRUCTED AS PART OF THIS CONTRACT BUT TO REMAIN PRIVATE.
 - FOR APPLICABLE SECTOR SCHEMES FOR WORKMANSHIP AND MATERIALS WITH ASSOCIATED APPENDICES, REFER TO APP 1/24 QUALITY MANAGEMENT SYSTEM PART E.
 - IN ACCORDANCE WITH THE CDM REGULATIONS RESIDUAL RISKS OF SIGNIFICANCE ARE INDICATED ON THE DRAWING ONLY BY MEANS OF A HAZARD TRIANGLE WITH APPROPRIATE NOTE.
 - THE CONTRACTOR SHALL CONDUCT THE WORKS WITH DUE REGARD TO THE ECOLOGICAL AND ENVIRONMENTAL REQUIREMENTS OF THE SCHEME.
 - THE CONTRACTOR SHALL TAKE SUCH STEPS TO SAFEGUARD AGAINST CONTAMINATION OF LOCAL WATERCOURSES.
 - TEMPORARY WORKS DESIGN ASSOCIATED WITH THE CONSTRUCTION OF THE WORKS SHALL BE THE RESPONSIBILITY OF THE CONTRACTOR.

VEHICLE PROFILE BELOW SHOWS VEHICLE USED FOR TRACK IN VIEWPORT 1-3

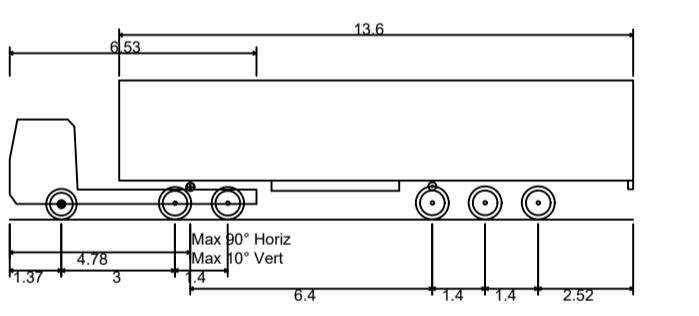

Max Legal Length (UK) Articulated Vehicle (16.5m)	16.500m
Overall Length	2.550m
Overall Width	3.681m
Min Body Ground Clearance	0.411m
Max Track Width	2.500m
Lock to lock time	6.00s
Kerb to Kerb Turning Radius	6.530m

VEHICLE PROFILE BELOW SHOWS VEHICLE USED FOR TRACK IN VIEWPORT 4

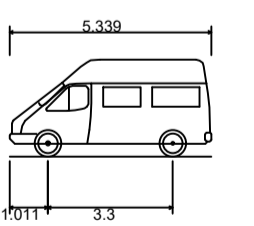

3.5t Panel Van	5.339m
Overall Length	1.986m
Overall Width	2.545m
Min Body Ground Clearance	0.338m
Track Width	1.986m
Lock to lock time	4.00s
Kerb to Kerb Turning Radius	6.400m

DRAFT VERSION ONLY

THIS DRAWING IS FOR DISCUSSION ONLY AND SHOULD BE CONSIDERED AS A DRAFT ONLY

SAFETY, HEALTH AND ENVIRONMENTAL INFORMATION

PLEASE REFER TO THE HEALTH AND SAFETY FILE FOR A FULL LIST OF THE RISKS ASSOCIATED WITH THIS WORK - THE FOLLOWING ARE THE MOST SIGNIFICANT RISKS TO BE AWARE OF.

CONSTRUCTION

- OPERATIVES TO TAKE PRECAUTIONS WHEN WORKING IN CLOSE PROXIMITY TO EXISTING PROPERTIES.
- ATTENTION TO BE GIVEN TO THE EXISTENCE OF SERVICES UNDERGROUND AND OVERHEAD LINES.

ENVIRONMENTAL

- EXISTING WATERCOURSES IN CLOSE PROXIMITY TO WORKS. A POLLUTION PREVENTION STRATEGY AND WORKING METHOD STATEMENTS TO BE PRODUCED BY THE CONTRACTOR FOR WORKS.
- CONSIDERATION GIVEN TO NOISE LEVELS GIVEN PROXIMITY TO EXISTING PROPERTIES.
- CONSIDERATION GIVEN TO GROUND CONDITIONS. CONTRACTOR TO REVIEW GEOTECHNICAL REPORT PRIOR TO UNDERTAKEN EXCAVATION WORKS.

WORK CAN ONLY BE CARRIED OUT BY SUITABLY TRAINED AND BRIEFED PERSONNEL.

		Client LONDON BOROUGH OF HAVERING	
www.slrconsulting.com		Project LOWER THAMES CROSSING	
Drawing Status & Suitability Code FOR INFORMATION S2		Drawing Title CONSTRUCTION TRAFFIC ROUTE SHEET 6 OF 6	
Designed JE	Drawn JE	Checked RT	Authorised RT
Date 16.11.23	Date 16.11.23	Date 16.11.23	Date 16.11.23
Drawing Number 065112-SLR-XXX-XXX-SK-CH-0007	Rev P01	Scale 1:500	SLR Project No. 425.065112.00001

Rev	Amendments	Date	By	Chk	Auth	Rev	Amendments	Date	By	Chk	Auth